



**IMPORTANT PERFORMANCE EXHAUSTS WARRANTY  
& INSTALLATION INSTRUCTIONS ATTACHED**

*Please Forward All Attached Information to Consumer  
Warranty Not Valid Unless Returned to CORSA Exhaust*

**We ask that you take a few moments to complete our warranty registration form:**

**TO ACTIVATE YOUR LIMITED LIFETIME WARRANTY GO TO:  
[CORSAPERFORMANCE.COM/WARRANTY](http://CORSAPERFORMANCE.COM/WARRANTY)**



**For Full-Color Installation Instructions, Please Visit:  
[CORSAPERFORMANCE.COM](http://CORSAPERFORMANCE.COM) and Search by Part Number**

Please be sure to review the enclosed instructions prior to beginning the installation process. If you have any questions about the enclosed parts, instructions or encounter a problem during installation:  
**CALL CORSA PERFORMANCE TECHNICAL ASSISTANCE AT 800.486.0999**

**Please take time to read and understand these installation instructions.**

CORSA recommends that the installation of this system be performed by a qualified service center or professional muffler installer who has the necessary equipment, tools and experienced personnel. However, if you decide to perform this install, the use of a hoist and an additional person will be required.

**CAUTION:** Never work on a hot exhaust system. Allow time for the vehicle to cool. Always wear eye protection when working under a vehicle.

**Recommended Tools:**

- Tape Measure
- Black marking pen
- 13mm & 15mm deep sockets and ratchet
- Chain style pipe cutters
- Grommet Pullers
- Soapy water
- Safety glasses
- Torque Wrench

**Please confirm that all parts are present before beginning the factory exhaust system removal and CORSA exhaust system installation.**

**Hardware Kit Bill of Materials:**

**Bill of Materials:**

1. Muffler Assembly (16SE2028)
2. Tip Assembly (16SE3000)
3. Dual "Y" Assembly (16SE4109)
4. Passenger Tailpipe Assembly (16SE4115)
5. Driver Tailpipe Assembly (16SE4116)
6. Driver Over the Axle Pipe (16SE4117)
7. Headpipe Assembly  
14867 - 119" WB (16SE4462)  
14869 - 143.5" WB (16SE4458)  
14870 - 153" WB (16SE4466)
8. Tip Assembly (16TA3000)
9. Hardware Kit (16SE7062)

1. 3" TORCA clamp
2. Anti Seize
3. 2.5" TORCA clamp
4. 5/16" Plain Washer
5. 5/16" Lock Washer
6. Threaded Backing Plate
7. Frame Mount Hanger Assembly
8. Rubber Hanger
9. Hex Head Bolt

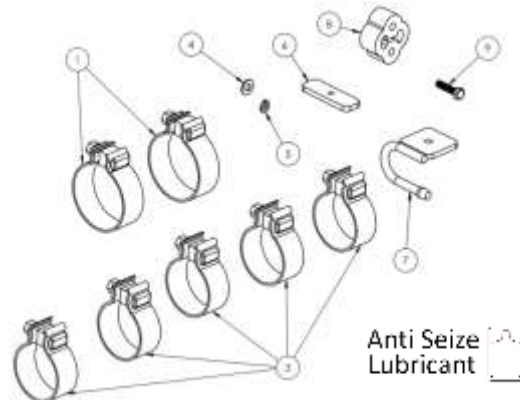

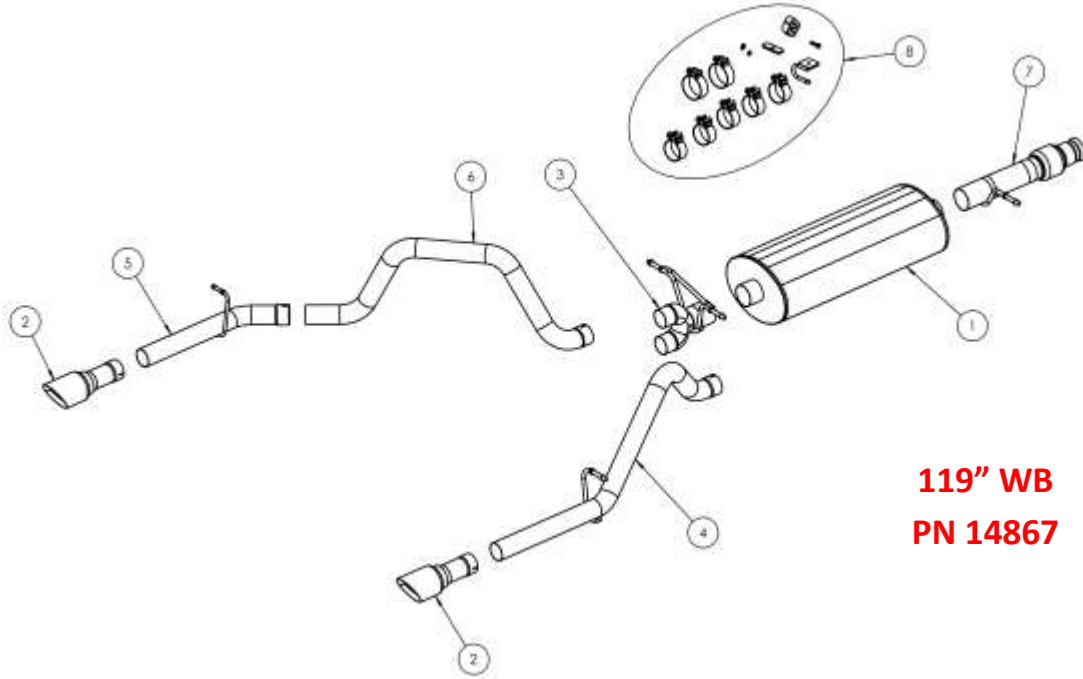

**119" WB**  
**PN 14867**

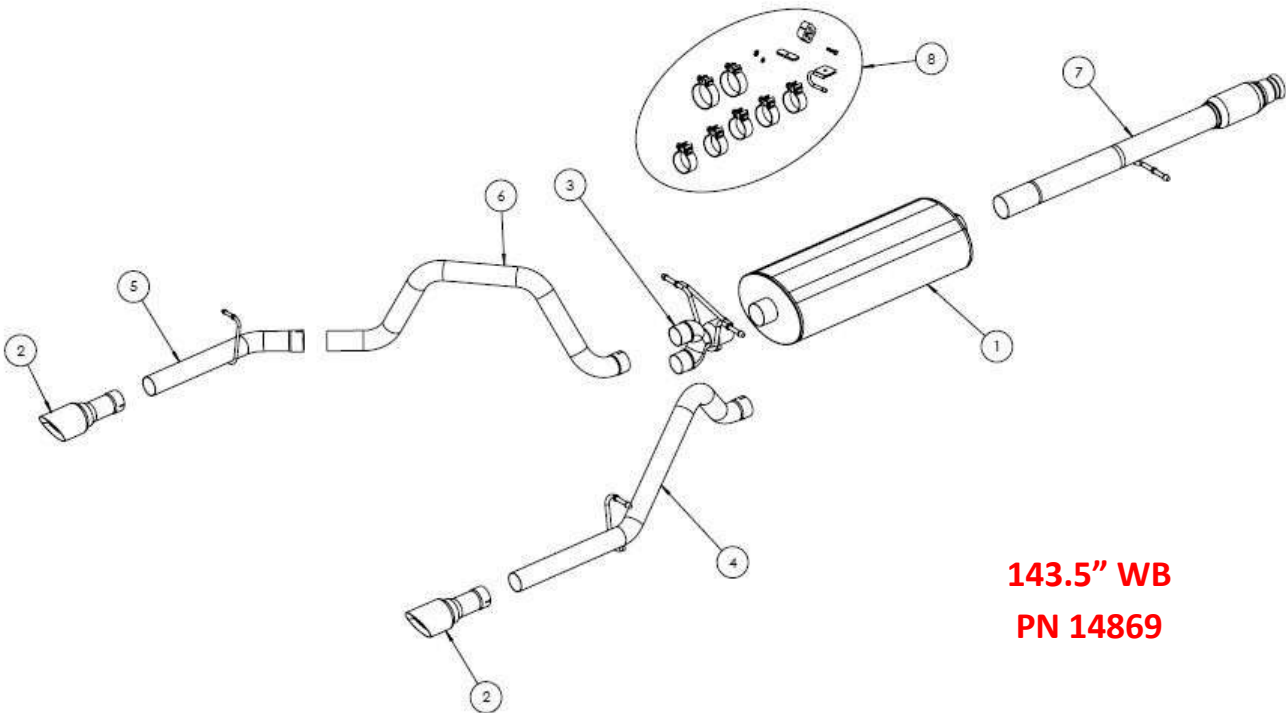

**143.5" WB**  
**PN 14869**

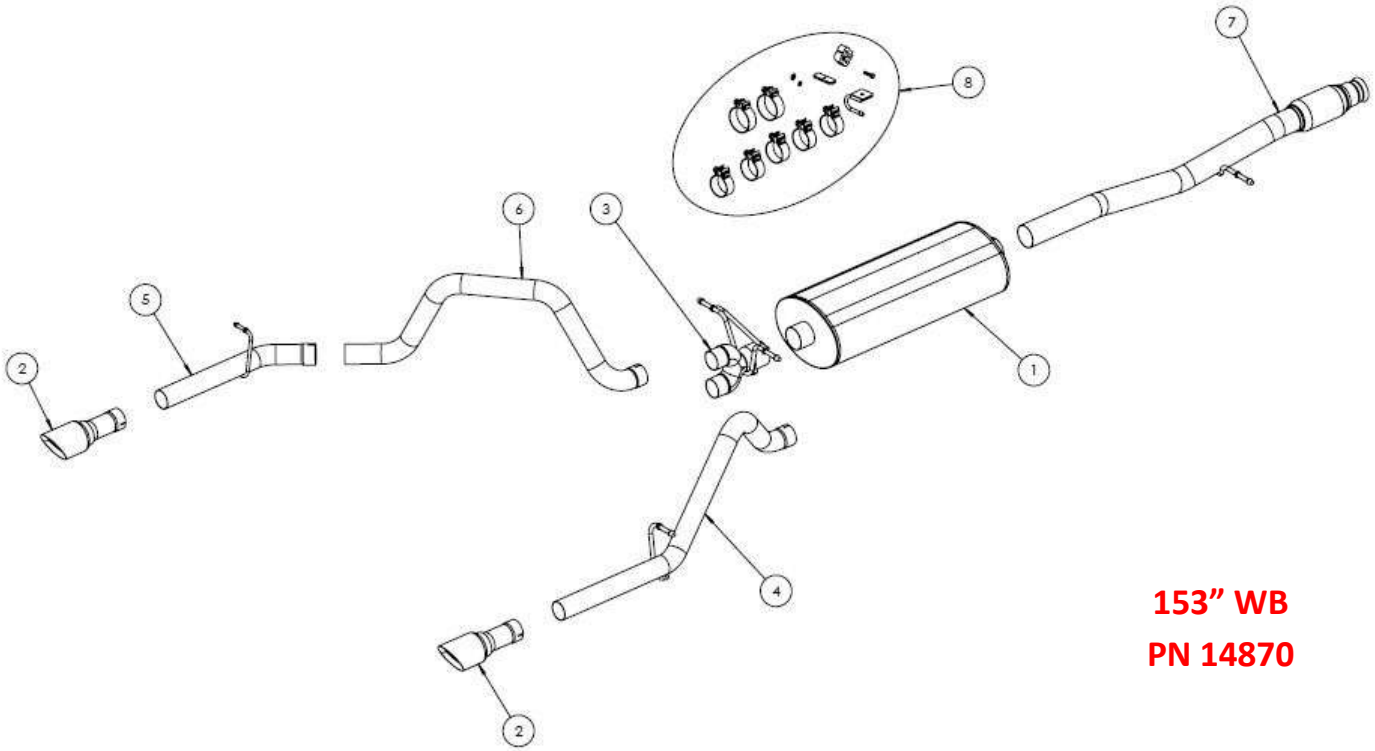

## Removal of Stock System:

1. Scribe a line 12" from the front face of the stock muffler. **(See Fig. A)**
2. Place a chain style cutter around the exhaust pipe at the scribe line location and cut the exhaust pipe. **(See Fig. B)**
3. Use a 13mm socket to loosen the spherical clamp and remove the factory headpipe. **(See Fig. C)**
4. Remove the grommets from the tailpipe hangers at the muffler exit, the spare tire and finally ahead of the muffler, using grommet pullers or similar device. **(See Fig's D, E & F)**  
**Note:** Using a soapy solution on the grommet hole will make the job easier.
5. Remove the muffler and rear tailpipe section from the vehicle by lifting the tailpipe over the rear axle and forwards toward the front of the vehicle. **(See Fig's G & H)**



FIG. A



FIG. B

*This completes the removal of the stock system.*



FIG. C



FIG. D



FIG. E



FIG. F



FIG. G

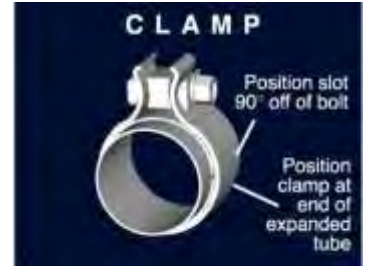

FIG. H

**For Technical Assistance:  
Call 800.486.0999**

## Installation of CORSA Exhaust System:

**NOTE:** Apply the anti-seize lubricant (supplied) to the threads **ONLY** of all the clamps and flange bolts. Failure to follow this procedure can cause nuts to seize on clamps and potentially destroy threads. After applying anti-seize lubricant, be sure to thoroughly clean your hands, as lubricant will tarnish stainless steel. All clamps should be tightened using a properly calibrated Torque Wrench. Using an air impact gun will damage the clamp and reduce its ability to effectively seal the joint. It may also cause the joint to separate, thereby causing damage to your exhaust system and to your vehicle.



**NOTE:** Align all clamps so that the center of the clamp bolt is 90 degrees from the notch in the pipe. (See Fig. CLAMP)

1. Locate the CORSA headpipe assembly and slide the spherical joint onto the factory pipe. Reuse the factory spherical clamp and loosely snug the spherical joint. Insert the hanger into the factory grommet. (See Fig. I)  
**Note:** Using a soapy solution on the grommet hole will make the job easier.
2. Slide a supplied 3" TORCA clamp over the inlet of the CORSA muffler. Make sure the weep hole is facing down then slide the muffler onto the headpipe and pre-tighten the clamp so it is snug but can still rotate. (See Fig's J, K & L)
3. Slide a supplied 3" TORCA clamp over the inlet of the CORSA Dual "Y" Assembly and insert over the muffler exit and place the hangers into the factory grommets. Pre-tighten the clamp. (See Fig's M, N, O & P)  
**Note:** Using a soapy solution on the grommet hole will make the job easier.
4. Slide a 2.5" TORCA clamp over the passenger side tailpipe assembly and place the pipe onto the upper end of the Dual "Y" Assembly and insert the hanger into the factory grommet. Pre-tighten the clamp at this time. (See Fig's Q, R, S & T)
5. Slide a 2.5" TORCA clamp over the "Driver Over the Axle Pipe" and place the pipe onto the lower end of the Dual "Y" Assembly. Leave the pipe loose at this time for adjustment when placing the driver side tailpipe onto the over the axle pipe. (See Fig's U, V & W)
6. Locate Driver Side tailpipe hanger assembly ("U" shaped Wire Loop & Plate) and hardware (threaded Mounting Plate, bolt and washers. (See Fig. X) On the driver side of the vehicle, position the threaded rectangular-shaped mounting plate on top of the frame rail over the hole located furthest forward from the rear of the frame rail. (See Fig's Y & Z)

**CONTINUE TO PAGE 7** 



7. Insert the supplied 5/16"-18 bolt through the tail pipe Wire Loop & Plate hanger and thread it into the threaded Mounting Plate on the top of the frame.  
**Note:** Position the driver side hanger so that it faces toward the spare tire (See Fig AA)
8. Slide a 2.5" TORCA clamp over the inlet of the driver's side tail pipe and install tail pipe onto the over the axle pipe. (See Fig's BB, CC & DD) Insert tail pipe into provided rubber grommet and pre-tighten clamp at this time.  
**Note:** Using a soapy solution on the grommet hole will make the job easier.
9. Locate exhaust tip assemblies and slide a 2.5" TORCA clamp over expanded end of tip assembly. With the bolt and nut facing up, snug fit the clamps on each tip assembly. Do not tighten at this time. (See Fig's EE & FF)
10. Check the alignment of tail pipe and tips. Make sure there is at least 1.5" clearance between the tips and the bottom of the bumper. Align tail pipe if necessary by making adjustments at the slip joints.
11. Starting from the front of the Corsa exhaust system, tighten the spherical clamp to **21 ft-lbs** and TORCA clamps to **45 ft-lbs** using a torque wrench. Make sure clamps are positioned and tightened as shown. (See Fig CLAMP)
12. It is strongly suggested that all clamps be checked and tightened if necessary after road testing the vehicle and after the system has cooled.

**NOTE:** During cold weather start-ups, you may experience an exhaust sound that is deeper and louder in tone than usual. This is temporary and will diminish to normal levels once your engine has reached its normal operating temperature.

**NOTE:** Immediately following the installation of your exhaust system, you may experience a trace of smoke after initial start-up. DO NOT be alarmed. The smoke is caused by the burning of a small amount of forming oil residue used in the manufacturing process.

**INSTALLATION PICTURES ON NEXT PAGE** 

**CORSA Installation Pictures:**



**FIG. I**



**FIG. J**



**FIG. K**



**FIG. L**



**FIG. M**



**FIG. N**



**FIG. O**



**FIG. P**



**FIG. Q**



**FIG. R**



**FIG. S**



**FIG. T**



**FIG. U**



**FIG. V**



**FIG. W**



**FIG. X**





FIG. Y



FIG. Z



FIG. AA



FIG. BB



FIG. CC



FIG. DD



FIG. EE



FIG. FF