



**IMPORTANT WARRANTY & INSTALLATION  
INSTRUCTIONS ATTACHED**

*Please Forward All Attached Information to Consumer  
Warranty Not Valid Unless Returned to CORSA Exhaust*

**We ask that you take a few moments to complete our warranty registration form:**

**TO ACTIVATE YOUR LIMITED LIFETIME WARRANTY GO TO:  
[CORSAPERFORMANCE.COM/WARRANTY](http://CORSAPERFORMANCE.COM/WARRANTY)**



**For Full-Color Installation Instructions, Please Visit:  
[CORSAPERFORMANCE.COM](http://CORSAPERFORMANCE.COM) and Search by Part Number**

Please be sure to review the enclosed instructions prior to beginning the installation process. If you have any questions about the enclosed parts, instructions or encounter a problem during installation:  
**CALL CORSA PERFORMANCE TECHNICAL ASSISTANCE AT 800.486.0999**

Please take time to read and understand these installation instructions.

CORSA recommends that the installation of this system be performed by a qualified service center or professional muffler installer who has the necessary equipment, tools and experienced personnel. However, if you decide to perform this install, the use of a hoist and an additional person will be required.

**CAUTION:** Never work on a hot exhaust system. Allow time for the vehicle to cool. Always wear eye protection when working under a vehicle.

### Recommended Tools:

- 13 mm Socket & Ratchet
- 15mm Socket
- Long Extension
- Torque Wrench
- Grommet Pullers
- Soap & Water Solution
- Safety Glasses

**Please confirm that all parts are present according to the bill of materials before beginning the installation.**

If something is missing call Tech Support at 1- 800-486-0999

#### Bill of Materials:

1. Tunnel Muffler Assembly
  2. Rear Muffler Assembly
  3. 4.0" Pro Series Tip Assembly (2)
  4. Axle Pipe Assembly
  5. 3.0" Cat-back Adapter Assembly
  6. Hardware Kit
  7. Vacuum Cap
- Anti-Seize Lubricant Packet

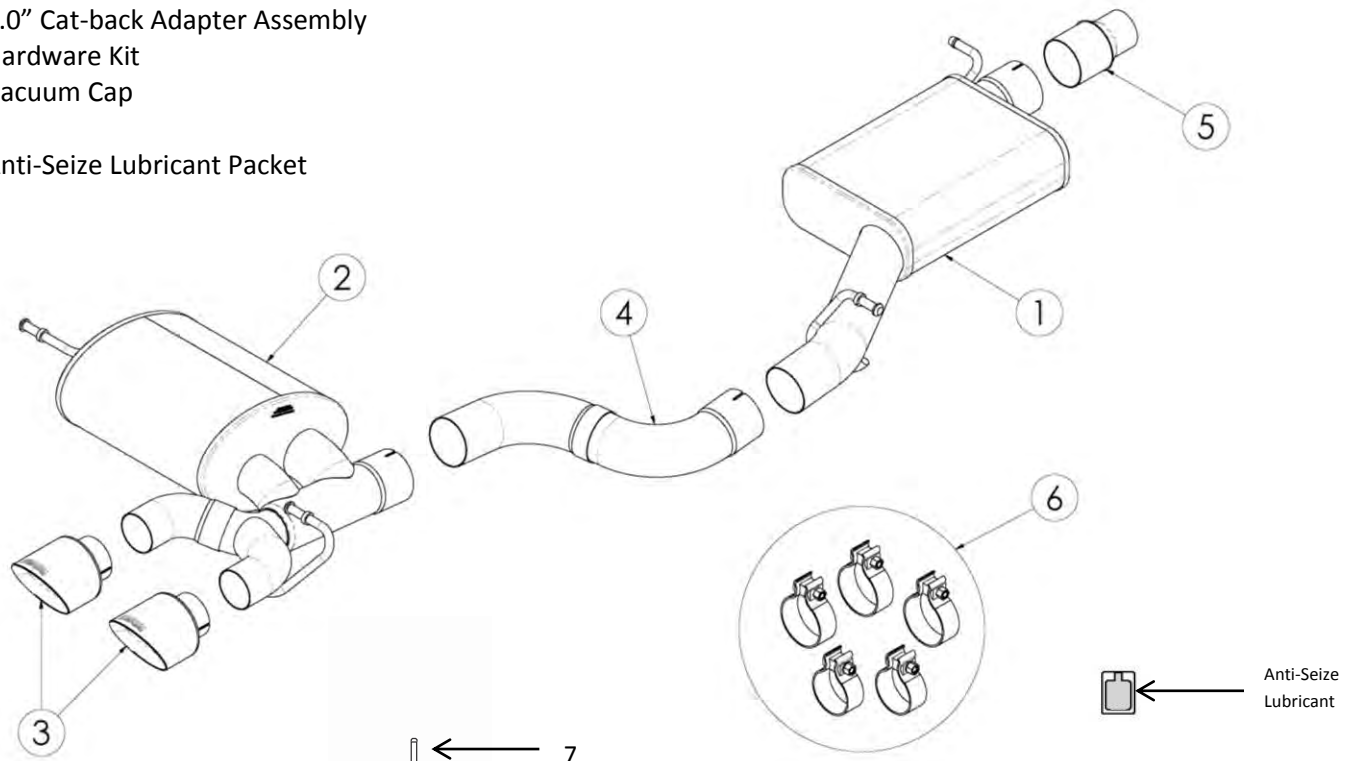

---

**Factory Exhaust System Removal:**

1. Using a 13mm socket and ratchet, loosen both nuts on the factory cat-back to downpipe clamp. **(Fig A)**
2. Using Grommet pullers or a similar device, remove the hanger near the front of the cat-back section from the grommet. **(Fig B)**  
**NOTE:** The use of a soapy water solution may aid in the removal and later installation of the hangers in the rubber isolators.
3. Remove the hanger near the middle of the factory cat-back section from the rubber isolator. **(Fig C)**
4. Locate and remove the vacuum line attached to the factory muffler. **(Fig D)**
5. Using a 13mm socket and a long extension, unbolt the left and right side hanger mounts from the vehicle by remove the two retaining bolts. **(Fig E, F)** Carefully slide the factory cat-back section back from the factory sleeve clamp and lower from the vehicle.
6. With the factory rear section on the ground, remove the hanger mounts from the factory system. Set aside both the rear muffler hanger mounts and retaining bolts to be reused during the installation process. **(Fig G, H)**. This completes the removal of the cat-back section.

**REMOVAL PICTURES ON NEXT PAGE** 

Factory Exhaust Removal Pictures



Fig. A



Fig. B



Fig. C



Fig. D



Fig. E



Fig. F

CONTINUES ON NEXT PAGE



Factory Exhaust Removal Pictures



Fig. G

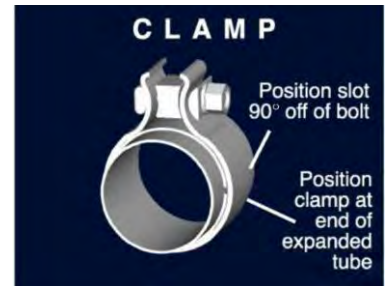

Fig. H

## Installation of CORSA Exhaust System:

**NOTE:** Apply the anti-seize lubricant (*supplied*) to the threads **ONLY** of all the clamps and flange bolts. Failure to follow this procedure can cause nuts to seize on clamps and potentially destroy threads. After applying anti-seize lubricant; be sure to thoroughly clean your hands, as lubricant will tarnish stainless steel. All clamps should be tightened using a properly calibrated Torque Wrench. Using an air impact gun will damage the clamp and reduce its ability to effectively seal the joint. It may also cause the joint to separate, thereby causing damage to your exhaust system and to your vehicle.

**NOTE:** Align all clamps so that the center of the clamp bolt is 90 degrees from the notch in the pipe. (See Fig. CLAMP)



1. Remove all exhaust system components from the shipping carton, including the three 3" clamps, the two 2.5" clamps, and the 3" cat-back adapter, which allows this system to be connected to the factory downpipe (if necessary).
2. Support the downpipe using an adjustable support stand (or equivalent), so that its outlet is in the approximate stock location.  
**NOTE:** If connecting to the factory downpipe, follow step 3, and then skip to step 5. If connecting to an aftermarket 3" downpipe, skip to step 4.
3. Locate the CORSA 3" cat-back adapter. Reuse the factory cat-back to downpipe sleeve clamp to connect the small end of the cat-back adapter to the factory downpipe. (See Fig. A) and tighten the clamp nuts with a 13mm socket and ratchet. Torque the clamp nuts to factory specifications.
4. If any non-CORSA aftermarket downpipe is installed, refer to the note after this step. If the CORSA downpipe kit for the Golf R was previously installed, locate the CORSA turbo-back connector pipe that was included in the downpipe kit. The previously used CORSA downpipe to stock cat-back adapter should now be removed and replaced by the CORSA turbo-back connector pipe. Reuse the 3" clamp that was on the downpipe to stock cat-back adapter; properly align the clamp on the connector pipe inlet, and slide it over the end of the CORSA lower downpipe assembly. Snugly tighten the 3" clamp to retain the connector pipe. (See Fig. B)  
**NOTE:** Your CORSA cat-back will mount directly to any downpipe that ends with a 3" diameter pipe section. However, additional fabrication may be necessary to adjust the length, size or outlet position of any non CORSA downpipe in order to properly mount to this CORSA cat-back system. **The CORSA downpipe for the Golf R will bolt to this cat-back system with no cutting or welding needed.**
5. Locate the CORSA<sup>®</sup> tunnel muffler assembly and a 3" clamp. Properly align the clamp on the expanded inlet of the tunnel muffler assembly and slide the inlet of the tunnel muffler onto the outlet of the downpipe adapter pipe. Insert the hangers on the tunnel muffler assembly into the factory rubber grommets. A Soapy water solution will aid in the installation process of the hangers. Snugly tighten the 3" clamp to retain the tunnel muffler section. (Fig C D & E)

CONTINUES ON NEXT PAGE



6. Locate the CORSA<sup>®</sup> axle pipe and a 3" clamp. Properly align the clamp on the expanded inlet of the axle pipe and slide the axle pipe onto the outlet of the tunnel muffler assembly. Align the axle pipe so that the outlet is centered in the vehicle and has proper clearance to all frame and suspension components. Snugly tighten the 3" clamp. **(Fig F, G)**
7. Locate the factory hanger mounting brackets that were removed earlier during the removal of the factory cat-back exhaust. Using a 13mm socket and ratchet, reinstall the factory hangers onto the vehicle paying attention to correct orientation of the hanger brackets. Hanger brackets should be oriented identical to stock. Leave the bolts slightly loose at this time.
8. Locate the supplied vacuum cap and cap the vacuum line that was connected to the factory rear muffler. Feed as much of the vacuum line into the bumper as possible and tuck away for clearance to the CORSA<sup>®</sup> exhaust. **(Fig H)**
9. Locate a 3" clamp and properly align it on the expanded inlet of the rear muffler assembly. Slide the inlet of the rear muffler assembly onto the outlet of the axle pipe. Install the rear muffler hangers into the factory grommets. **(Fig I, J)**
10. Align the muffler outlets so that they are centered in the tip openings in the rear fascia. Snugly tighten the muffler clamp and factory hanger bracket bolts at this time. **(Fig K)**
11. Locate the CORSA<sup>®</sup> tip assemblies and the two 2.5" clamps. Properly align the clamp on the tip assembly inlet and slide the tips onto the muffler outlet pipes. Both clamps should be oriented so that the bolt is on top and pointing toward the passenger side of the vehicle. Installing the driver side tip first and loosely tightening the clamp, followed by installing the passenger side tip and loosely tighten the clamp will make the installation easier. There are multiple access points in the fascia & bumper that will allow the use of various extensions to tighten the tip clamps. **(Fig L)**
12. Align the tips so that they are centered, rotated square to the vehicle, and even depth with each other. Loosely snug the tip clamps at this time.
13. Visually inspect the exhaust system position tip alignment, clamp orientation, and all exhaust system clearances. Make any necessary adjustments at the slip joints and at the front downpipe bracket. .
14. When the exhaust system is in the desired location, tighten the nuts on the clamps. Torque nuts to 45ft-lbs (61N-m).
15. It is strongly suggested that all clamps be checked and re-tightened (if necessary) to the recommended torque after initial road testing of the vehicle, as thermal cycling has occurred on the system. Please wait until system has fully cooled to perform this step.

**NOTE:** During cold weather start-ups, you may experience an exhaust sound that is deeper and louder in tone than usual. This is temporary and will diminish to normal levels once your engine has reached its normal operating temperature.

**NOTE:** Immediately following the installation of your exhaust system, you may experience a trace of smoke after initial start-up. DO NOT be alarmed. The smoke is caused by the burning of a small amount of forming oil residue used in the manufacturing process.

**INSTALL PICTURES ON NEXT PAGE** 



**CORSA Exhaust Installation Pictures**



Fig. A



Fig. B



Fig. C



Fig. D



Fig. E



Fig. F

CONTINUES ON NEXT PAGE 

**CORSA Exhaust Installation Pictures**

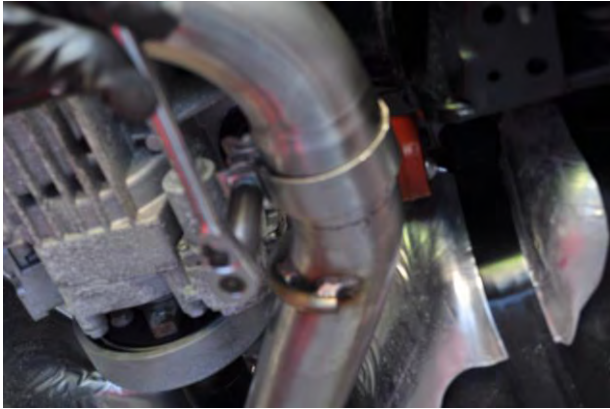

Fig. G



Fig. H



Fig. I



Fig. J



Fig. K

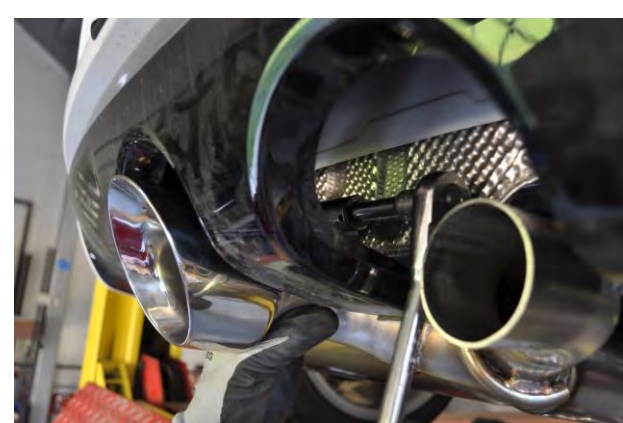

Fig. L